



FCBA N° 2010.461.1208

HardWood Clip®



HIDDEN FASTENERS WITH STAINLESS STEEL REINFORCEMENT

Timber decking and cladding

THE ULTIMATE GENERATION
OF HIDDEN FASTENERS



www.novlek.com



HIDDEN FASTENERS

WITH STAINLESS STEEL REINFORCEMENT

BENEFITS



SCREWING BOARDS
ONTO JOISTS



REVERSIBLE BOARDS
BOTH SIDES CAN BE USED



QUICK AND EASY INSTALLATION
40% TIME SAVINGS



EXTREME STABILITY
IN ALL WEATHERS



REGULAR, EVEN SPACING
BETWEEN BOARDS ALL YEAR
ROUND



ABSORBS SWELLING
OF THE BOARDS



EXCEPTIONAL MECHANICAL
STRENGTH



EXTREMELY DURABLE



UNCOMPROMISING QUALITY
AND PERFORMANCE

High hardness AISI 304 stainless steel reinforcement

Provides unparalleled rigidity and strength to the fastener, ensuring the board is properly clamped to the joist, and the decking is highly stable, even with the hardest woods.



Plastic resin shell

High performance polymer to cope with the mechanical and physical stresses on the fastener.

Gripping ribs

Hold the fastener in place while it is being screwed in.

Integrated spacer

Ensures appropriate, constant and even spacing between boards. It is designed to absorb the swelling of the boards without damaging the wood.

3 thicknesses available: 3, 5 and 7 mm.

Protective cover for the stainless steel reinforcement

Protects the stainless steel reinforcement, preventing damage to it from the screw head during screwing. Guarantees durability of the fastener.



Black antireflective finish

Ensures full UV protection, as well as complete discretion. Does not reflect the sun's rays or light.

Patented fastener



Stainless steel screw A2 AISI 304

Highly resistant to a saline atmosphere. Solid "Antique" colour stainless steel.



Small head

Ground serrations, Torx SPAX T-STAR plus.

SPAX ground serrations profile

CUT point

For fast, safe screwing.

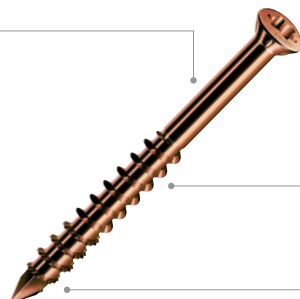



Click on the photo to watch the video

USE

HardWood Clip® is the most advanced, effective fastening system on the market for timber decking and cladding, thanks to its exclusive and outstanding technical characteristics.

The invisible HardWood Clip® fasteners ensure complete stability over time, along with their high-end aesthetic and unparalleled durability.

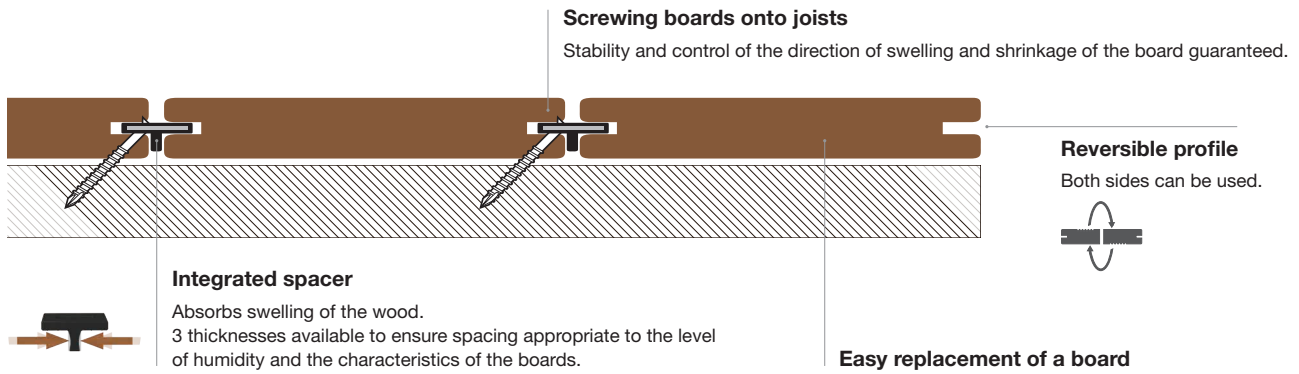

USE *	TROPICAL WOOD **	BROAD-LEAVED SPECIES	RESINOUS WOOD	MODIFIED WOOD			
		OAK CHESTNUT **		ACCOYA® **	KEBONY®	HEAT-TREATED	BAMBOO
Residential	✓	✓	✗	✓	✓	✓	✓
Public / Commercial	✓	✓	✗	✓	✓	✗	✓
Coastal	✓	✓	✗	✓	✓	✓	✓
Decking	✓	✓	✗	✓	✓	✓	✓
Pool beaches	✓	✓	✗	✓	✓	✓	✓
Cladding	✓	✓	✗	✓	✓	✓	✓

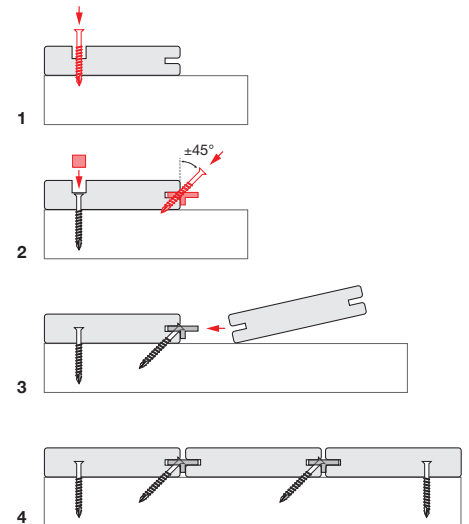

* Scrupulously respect the requirements linked to the chosen species (NF B 54-040), the requirements of the standards and regulations in force (notably NF-DTU 51.4 and 41.2), maximum width/thickness ratio values, installation and grooving instructions, manufacturer's instructions, regulations in force and good practices. Some varieties must be used with special care or are to be avoided, due, notably to their unstable nature, to their range of movement, to their fragility or certain specific properties that could give rise to weaknesses with respect to the boards. For further information, please contact your retailer, your timber supplier or send an e-mail to info@novlek.com.

** Respect the conclusions and recommendations of product description and evaluation folders produced by the FCBA (see COMPLIANCE below).



COMPLIANCE

DTU 51.4 Fastening requirements for decking boards

HardWood Clip® is the only invisible fastening system to have had three technical evaluations confirming its compliance with the requirements of standard NF DTU 51.4 covering fasteners for decking boards.

- Tropical species :** FCBA-2010.461.1263
- Oak and chestnut :** FCBA-2018.387.1177
- Accoya® :** FCBA-DT 2016.511.2348



The FCBA has assessed the HardWood Clip® fasteners as compliant with the requirements of DTU 51.4 for wooden planking. HardWood Clip® meets all the various criteria and acceptability thresholds specified in the DTU 51.4 for resistance to tearing and shearing, as well as for stability of the planking (tolerances on the finished planking and during its working life).

HIDDEN FASTENERS

WITH STAINLESS STEEL REINFORCEMENT

3 SIZES TO GUARANTEE APPROPRIATE SPACING BETWEEN BOARDS



Models	S	M	L
Spacing between boards during installation	<p>3 mm</p>	<p>5 mm</p>	<p>7 mm</p>
Use* (moisture content of the boards during installation)	<p>18%</p>	<p>18%</p>	<p>18%</p>
Max. allowed swelling	0 mm	4 mm	6 mm
Max. allowed shrinking	10 mm	9 mm	8 mm
Materials	Polypropylene and fibreglass Stainless steel AISI 304	Polyethylene Stainless steel AISI 304	Polyethylene Stainless steel AISI 304
Colour	Black, anti-reflection	Black, anti-reflection	Black, anti-reflection
UV resistance	Yes	Yes	Yes
Resistance to high and low temperatures	Excellent	Excellent	Excellent

* To be adjusted on a case-by-case basis, depending, notably on the species, width boards, environment, exposure and climate conditions. Respect the requirements of DTU 51.4.

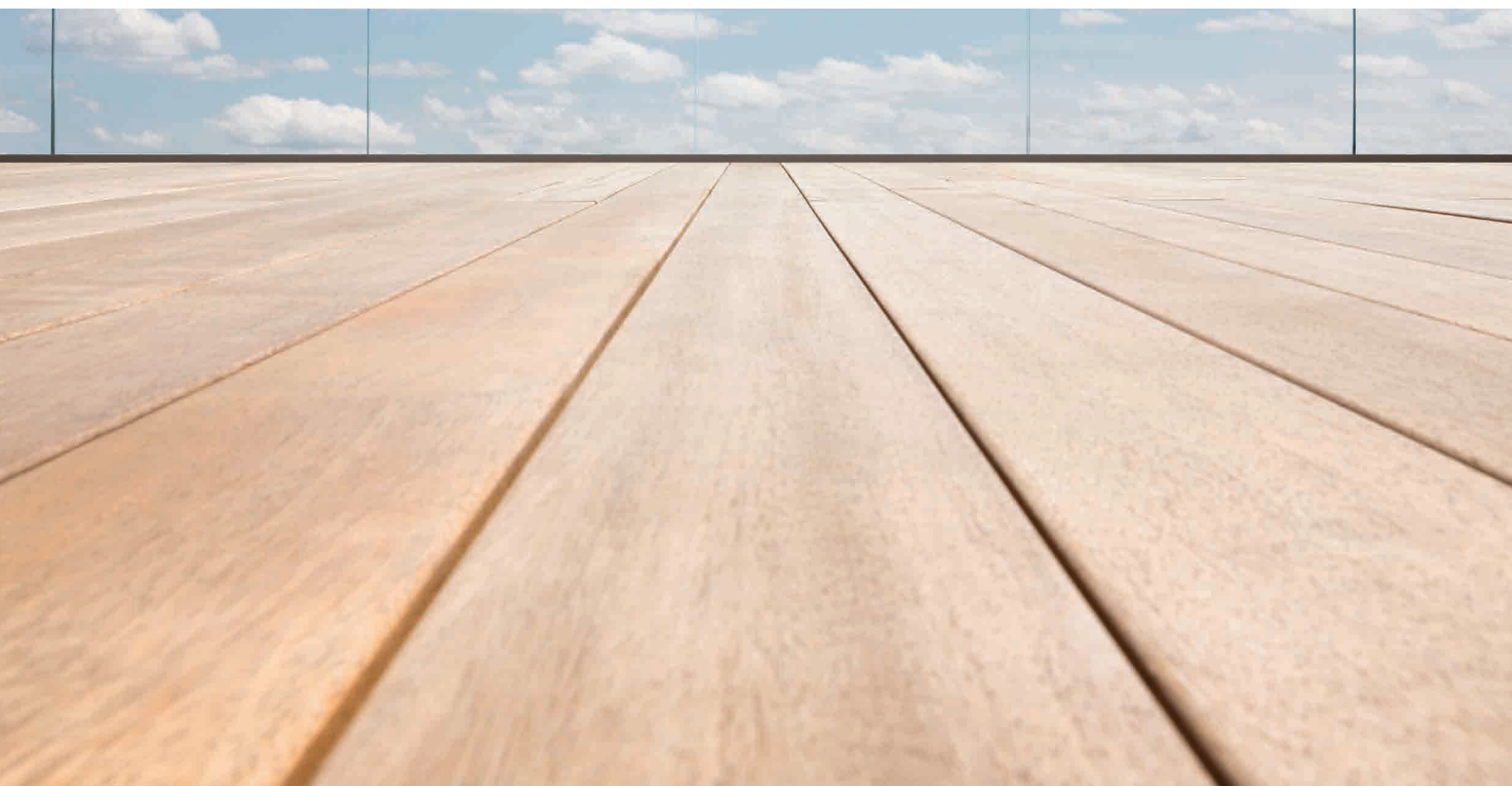



PROFILES

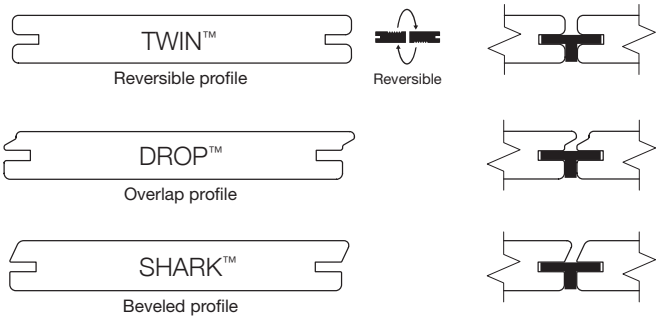

	TWIN™	DROP™	SHARK™
Decking	•	•	•
Vertical cladding	•	•	•
Horizontal cladding	Sheltered or interior	•	•

Available in various finishes, thicknesses from 20 mm and widths up to 145 mm. Other larger sizes, depending on species, thickness, installation conditions, etc.

GROOVING



Grooving along the whole length, with a 4-sided planer or spindle moulder.



Local grooving, with a Lamello® type biscuit joiner or a router.

HIDDEN FASTENERS

WITH STAINLESS STEEL REINFORCEMENT

SPECIES ACCEPTABLE FOR THE HARDWOOD CLIP® FASTENING SYSTEM

TROPICAL SPECIES			
Acceptable board width	Stable (S)	Moderately stable (MS)	Unstable (PS)
< 140 mm	HardWood Clip <i>complies with DTU 51.4¹</i>	HardWood Clip <i>complies with DTU 51.4¹</i>	✘
140 - 145 mm	HardWood Clip <i>complies with DTU 51.4¹</i>	HardWood Clip <i>complies with DTU 51.4¹</i>	✘

The use of HardWood Clip® fasteners with certain tropical species such as Bilinga, Bangkirai, Yellow Cumaru, Tali, etc. that the NF B 54-040 standard classifies as moderately stable (MS) must be studied on a case-by-case basis, as special attention is required, in particular because of the problems that their properties could create. FCBA recommends local grooving for moderately stable species such as Bangkirai which has a big difference between tangential and radial coefficients of shrinkage.

The use of HardWood Clip® hidden fasteners is not recommended with tropical wood species that the NF B 54-040 standard classifies as unstable (PS) due to their particular physical properties and lack of stability, especially when drying out.

TEMPERATE HARDWOODS			
Acceptable board width	Stable (S)	Moderately stable (MS)	Unstable (PS)
≤ 110 mm	-	HardWood Clip <i>complies with DTU 51.4²</i>	✘

The use of HardWood Clip® hidden fasteners is not recommended with temperate wood species that the NF B 54-040 standard (Robinia) classifies as unstable (PS) due to their particular physical properties and lack of stability, especially when drying out.

SOFTWOOD SPECIES (EXCLUDING THERMO-MODIFIED)			
Acceptable board width	Stable (S)	Moderately stable (MS)	Unstable (PS)
-	-	✘	-

HardWood Clip® fasteners should not be used with non-heat-treated softwood boards.

MODIFIED WOOD AND BAMBOO (NOT HANDLED BY NF DTU 51.4, EXCEPT FOR ACCOYA®)			
Acceptable board width	Stable (S)	Moderately stable (MS)	Unstable (PS)
< 140 mm	HardWood Clip <i>ACCOYA® : complies with DTU 51.4³</i>	-	-
140 - 145 mm	HardWood Clip <i>ACCOYA® : complies with DTU 51.4³</i>	-	-
> 145 mm	HardWood Clip <i>ACCOYA® : complies with DTU 51.4³</i>	-	-

Whatever the wood species of the boards, the requirements of NF DTU 51.4 and NF B 54-040 must be scrupulously respected, as must FCBA recommendation (see test reports below) and the installation instructions supplied with HardWood Clip® fasteners.



Click on the photo
to watch the video

INSTALLATION USING STANDARD BOARDS AND LOCAL GROOVING

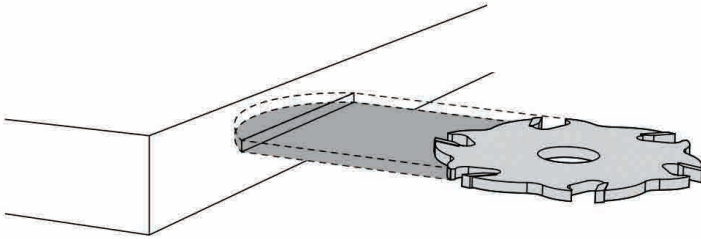

HardWood Clip® hidden fasteners can be fitted quickly and easily to standard solid-edge boards

ADVANTAGES



SUITABLE FOR STANDARD
BOARDS



FASTER THAN TRADITIONAL
SCREW INSTALLATION



EDGE STRENGTH SIMILAR TO A
STANDARD SOLID EDGE BOARD



EDGE STABILITY SIMILAR TO A
STANDARD SOLID EDGE BOARD



VERY EASY AND QUICK TO
GROOVE WITH A BISCUIT
JOINER



SOLUTION TO AN INFINITE
NUMBER OF SITUATIONS
TOTAL FREEDOM



HIDDEN FASTENERS

WITH STAINLESS STEEL REINFORCEMENT

USE FOR CLADDING



HardWood Clip® invisible fasteners guarantee quick and easy installation of cladding boards thanks to its integrated spacer, which automatically ensures they are correctly spaced and perfectly parallel to each other.

Having the boards screwed to their supports with HardWood Clip® fasteners makes installation much easier, and also guarantees their strength, stability and beauty over the lifetime of the facade covering.

HardWood Clip® ensures they are firmly fixed, whether laid horizontally or vertically.

The various technical profiles available for HardWood Clip® provide a solution for every cladding project, whether with closed or opened joints, domestic or public.

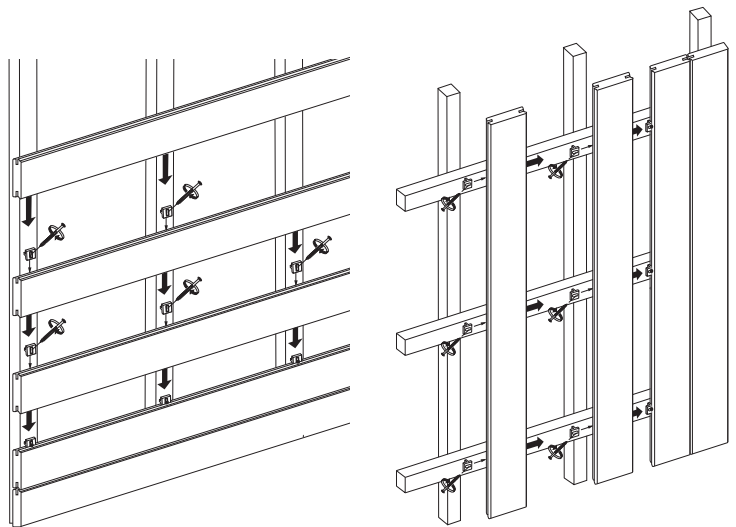



HIDDEN FASTENERS WITH STAINLESS STEEL REINFORCEMENT



- ± 7m²
90mm
- ± 10m²
120mm
- ± 11m²
140mm

CONTENTS

- x 185
- x 200
- x 1
- x 2
- x 12
- x 3

Hardwood Clip® CLASSIC | ± 11 m²

Estimate based on board width of 140 mm and joists centre to centre distance of 45 cm

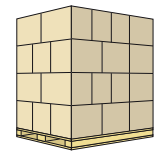

Model	Article code	EAN code	Kit		Box 8 Kits/Box		Pallet 288 Kits/Pallet	
			Dimensions (mm)	Weight	Dimensions (mm)	Weight	Dimensions (mm)	Weight
S - 3 mm	HW-S-185-12	5425 03355 000 4	245 x 190 x 95	2,05 kg	395 x 260 x 400	16,80 kg	1200 x 800 x 1750	630 kg
M - 5 mm	HW-M-185-12	5425 03355 001 1	245 x 190 x 95	2,00 kg	395 x 260 x 400	16,40 kg	1200 x 800 x 1750	615 kg
L - 7 mm	HW-L-185-12	5425 03355 002 8	245 x 190 x 95	2,04 kg	395 x 260 x 400	16,70 kg	1200 x 800 x 1750	626 kg

Plug variants

HardWood Clip® CLASSIC is available, at no extra cost, with wooden plugs in the following species (article codes below):

Model	Padouk	Kebony®	Larch	Cumaru	Merbau
S - 3 mm	HW-S-185-12_2	HW-S-185-12_4	HW-S-185-12_5	HW-S-185-12_6	HW-S-185-12_7
M - 5 mm	HW-M-185-12_2	HW-M-185-12_4	HW-M-185-12_5	HW-M-185-12_6	HW-M-185-12_7
L - 7 mm	HW-L-185-12_2	HW-L-185-12_4	HW-L-185-12_5	HW-L-185-12_6	HW-L-185-12_7



HIDDEN FASTENERS WITH STAINLESS STEEL REINFORCEMENT



± 17m ²	90mm
± 24m ²	120mm
± 27m ²	140mm

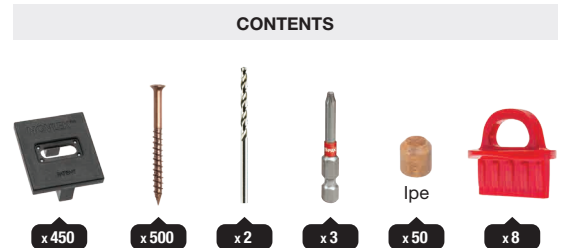

Hardwood Clip®

PRO | ± 27 m²

Estimate based on board width of 140 mm and joists centre to centre distance of 45 cm

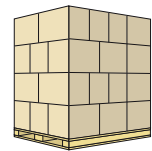
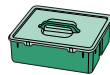

Model	Article code	EAN code	Kit		Box 3 Kits/Box		Pallet 108 Kits/Pallet	
			Dimensions (mm)	Weight	Dimensions (mm)	Weight	Dimensions (mm)	Weight
S - 3 mm	HW-S-450-12	5425 03355 010 3	360 x 270 x 140	4,95 kg	376 x 281 x 400	15,35 kg	1200 x 1000 x 1750	578 kg
M - 5 mm	HW-M-450-12	5425 03355 011 0	360 x 270 x 140	4,86 kg	376 x 281 x 400	15,08 kg	1200 x 1000 x 1750	568 kg
L - 7 mm	HW-L-450-12	5425 03355 012 7	360 x 270 x 140	4,91 kg	376 x 281 x 400	15,25 kg	1200 x 1000 x 1750	574 kg

Plug variants

HardWood Clip® PRO is available, at no extra cost, with wooden plugs in the following species (article codes below):

Model	Padouk	Kebony®	Larch	Cumaru	Merbau
S - 3 mm	HW-S-450-12_2	HW-S-450-12_4	HW-S-450-12_5	HW-S-450-12_6	HW-S-450-12_7
M - 5 mm	HW-M-450-12_2	HW-M-450-12_4	HW-M-450-12_5	HW-M-450-12_6	HW-M-450-12_7
L - 7 mm	HW-L-450-12_2	HW-L-450-12_4	HW-L-450-12_5	HW-L-450-12_6	HW-L-450-12_7



FCBA N° 2010.461.1208



HIDDEN FASTENERS

WITH STAINLESS STEEL REINFORCEMENT



± 19 m²

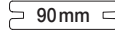

± 26 m²

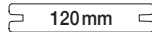

± 30 m²

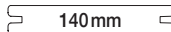

CONTENTS



Hardwood Clip®

PRO Refill | ± 30 m²

Estimate based on board width of 140 mm and joists centre to centre distance of 45 cm

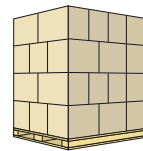

Model	Article code	EAN code	Kit		Pallet 99 Kits/Palet	
			Dimensions (mm)	Weight	Dimensions (mm)	Weight
S - 3 mm	HW-S-RF500-12	5425 03355 018 9	360 x 270 x 140	4,95 kg	1200 x 1000 x 1750	578 kg
M - 5 mm	HW-M-RF500-12	5425 03355 019 6	360 x 270 x 140	4,86 kg	1200 x 1000 x 1750	568 kg



reddot design award
winner 2010



FCBA N° 2010.461.1208



REFILL PRO: AN ECO-FRIENDLY AND ECONOMICAL SOLUTION



The **REFILL** for the HardWood Clip® PRO kit allows the craft worker to reuse the HardWood Clip® PRO plastic box almost indefinitely when it is empty whenever necessary.

NÖVLEK® has developed the **REFILL** to provide craft workers with a solution that reduces packaging materials on-site and facilitates their disposal, as well as combatting unnecessary waste by optimising and streamlining its contents.

Choosing **REFILL** PRO allows you to optimise your purchases and makes life easier on the site, in addition to protecting our planet.

BENEFITS



WASTE
REDUCTION



ECO-FRIENDLY SOLUTION
100% RECYCLED CARDBOARD
100% RECYCLABLE



ECONOMICAL
STREAMLINING OF CONTENTS
ANTI-WASTE

Eco-friendly packaging

99% less plastic.
No overpackaging.

100% recycled and 100% recyclable FSC cardboard

Cardboard waste is not bulky and is easy
to dispose of and recycle.



Reuse of the PRO box and spacers

Once empty, the PRO case can be refilled with the REFILL and reused almost indefinitely, as can the spacers supplied with it.

The REFILL means no more piles of plastic boxes and hundreds of spacers and plugs that you don't know what to do with.



Streamlined and anti-waste contents

The REFILL PRO only contains fasteners, screws, Torx bits and pre-drilling bits. Other components (spacers, plugs) are not included in the REFILL because they are already part of the basic PRO case which can be filled when empty.

The quantity of fasteners matches the number of screws because the additional screws needed for the start and end boards or other finishes are also included in the basic kit.

HIDDEN FASTENERS

WITH STAINLESS STEEL REINFORCEMENT

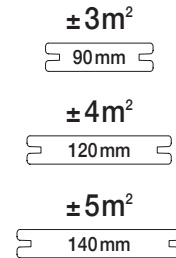

CONTENTS



Hardwood Clip®

MINI | ± 5 m²

Estimate based on board width of 140 mm and joists centre to centre distance of 45 cm

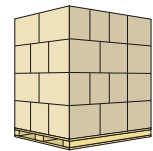

Model	Article code	EAN code	Kit		Box 3 Kits/Box		Pallet 168 Kits/Pallet	
			Dimensions (mm)	Weight	Dimensions (mm)	Weight	Dimensions (mm)	Weight
S - 3 mm	HW-S-85-12	5425 03355 020 2	155 x 120 x 125	0,97 kg	365 x 160 x 135	3,05 kg	1200 x 800 x 690	196 kg
M - 5 mm	HW-M-85-12	5425 03355 021 9	155 x 120 x 125	0,95 kg	365 x 160 x 135	2,98 kg	1200 x 800 x 690	192 kg
L - 7 mm	HW-L-85-12	5425 03355 022 6	155 x 120 x 125	0,95 kg	365 x 160 x 135	2,98 kg	1200 x 800 x 690	192 kg



reddot design award
winner 2010



FCBA N° 2010-461.1208

